

# GROUP ONE - IN-GROUND DIRECT ACTING SINGLE, 2, & 3 STAGE

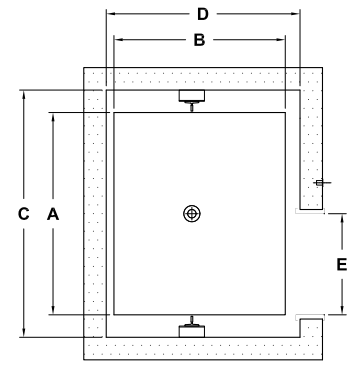
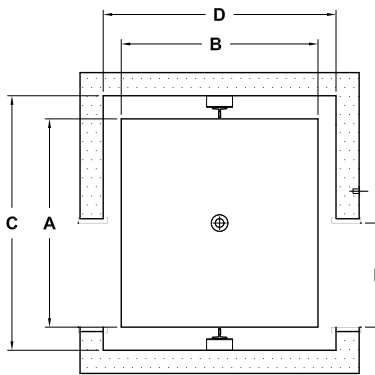
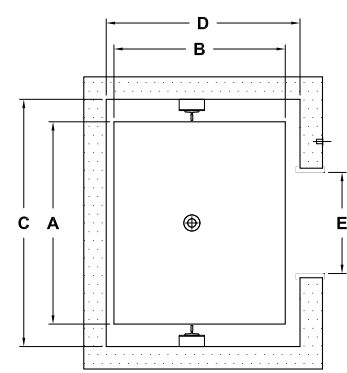
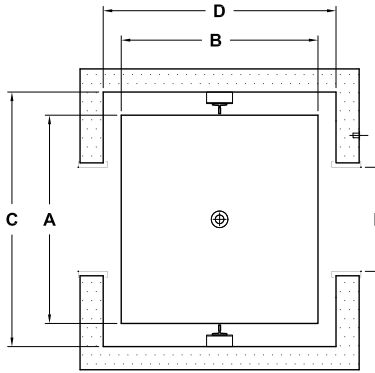
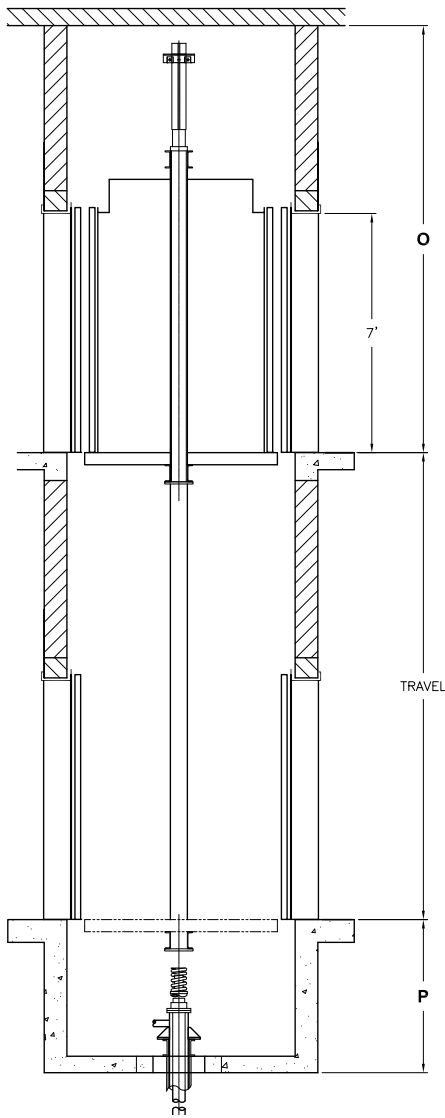

**A = PLATFORM WIDTH    C = HOISTWAY WIDTH    E = CLEAR DOOR OPENING    P = PIT DEPTH**  
**B = PLATFORM DEPTH    D = PLATFORM DEPTH    O = OVERHEAD**

EECO engineering presents one of the simplest elevator systems available.

It utilizes either a single-stage or a multi-stage telescopic hydraulic jack installed in the ground.

The jack is located directly under the car, near the center of the platform.

Capacity (lbs)	Platform A x B	Hoistway C x D	Front/Rear	Clear Inside W x D	Door Type	Door Width E
2100	6'-0" x 5'-1"	7'-4" x 5'-9"	F	5'-8" x 4'-3"	1-SP	3'-0"
2100	6'-0" x 5'-8"	7'-4" x 6'-8 1/2"	F/R	5'-8" x 4'-4"	1-SP	3'-0"
2500	7'-0" x 5'-1"	8'-4" x 5'-9"	F	6'-8" x 4'-3"	1-SP	3'-6"
2500	7'-0" x 5'-8"	8'-4" x 6'-8 1/2"	F/R	6'-8" x 4'-4"	1-SP	3'-6"
3000	7'-0" x 5'-6"	8'-4" x 6'-2"	F	6'-8" x 4'-8"	1-SP	3'-6"
3000	7'-0" x 6'-1"	8'-4" x 7'-1 1/2"	F/R	6'-8" x 4'-9"	1-SP	3'-6"
3500	7'-0" x 6'-2"	8'-4" x 6'-10"	F	6'-8" x 5'-4"	1-SP	3'-6"
3500	7'-0" x 6'-9"	8'-4" x 7'-9 1/2"	F/R	6'-8" x 5'-5"	1-SP	3'-6"
4500H	6'-0" x 9'-2"	7'-4" x 10'-0"	F	5'-8" x 8'-2 1/2"	2-SP	4'-0"
4500H	6'-0" x 9'-10 1/2"	7'-4" x 11'-2"	F/R	5'-8" x 8'-3 1/2"	2-SP	4'-0"

Verify all dimensions with EECO prior to construction. Consult EECO Engineering for required overhead and pit depth dimensions.